

# Model HC8000

## Electronic Sump Pump Switch

Patents Pending

**HydroCheck**  
Controlling Water.  
Preventing Damage.

### Installation Instructions

#### Overview

The installation of the HC8000 Sump Pump Switch is simple and straightforward, but there are **TWO VERY IMPORTANT** things to remember for HC8000 to give you years of trouble free, worry free, service:

1. The “piggyback plug” attached to the mechanical float switch **cannot be used with the HC8000**. It must be disconnected and remain disconnected. Just let it lay on the floor after the HC8000 is installed.
2. If your sump pump has internal float switch wiring, i.e. doesn't have a “piggyback plug,” then you **MUST** secure the float up as if the pit were full so that the internal switch is always closed and the pump enabled.

#### Step-by-Step Installation

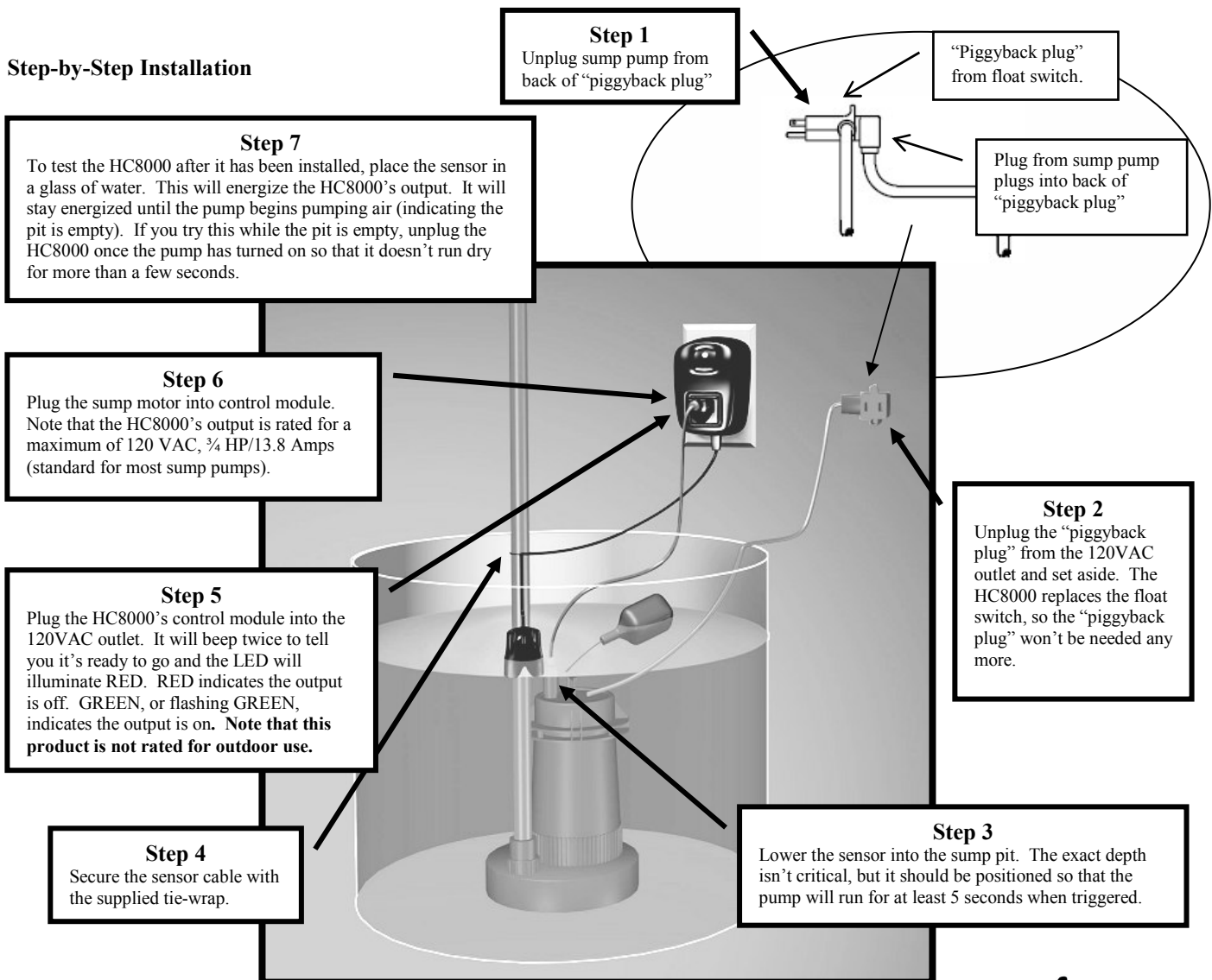

**STAK**<sup>™</sup>  
enterprises, inc.  
471-A Jennings Drive Lake in the Hills IL 60156

Questions or Comments Contact Us At:  
[www.hydrocheckproducts.com](http://www.hydrocheckproducts.com) or [info@hydrocheckproducts.com](mailto:info@hydrocheckproducts.com) or 877-225-2124

## HC8000 Sump Pump Switch Troubleshooting Chart

The Model HC8000 Sump Pump Switch has a number of built in alarms that warn of problems with the pump or discharge plumbing. The available alarms are described in the table below.

Alarm/Indicator	Description	Possible Causes
2 Beeps	Can't turn pump on	Pump not plugged in Float piggy-back plug not disconnected Float switch not secured in "on" position (internally wired float switch)
3 Beeps	High Level Alarm	Pump can't keep up with water coming in Discharge plumbing blocked Debris on sensor
Steady Slow Beep*	Motor current above normal	Restriction in discharge plumbing Pump motor beginning to fail
Steady Fast Beep*	Motor current too high	Severely restricted discharge plumbing Pump motor failure imminent
Steady Red LED	Pump off, no water detected	
Flashing Red LED	Pump off, no water detected, controller in short cycle mode	If, during a calibration cycle, the controller does not detect the drop in motor current indicating an empty pit, it defaults to a 6 second cycle time to protect the pump motor from being run dry
Steady Green LED	Pump on, water detected by sensor	
Slow Flashing Green LED	Pump on, water below sensor, timed cycle	
Fast Flashing Green LED	Pump on, water below sensor, looking for change in motor current indicating loss of suction	

\*The HC8000 needs to be reset after replacing the pump by performing the following steps:

1. Unplug the pump from the HC8000
2. Unplug the HC8000 from the 120 VAC outlet
3. Wait 5 seconds then plug the HC8000 back into the 120 VAC outlet
4. Wait for the HC8000 to finish its startup checks (about 5 seconds) then plug the pump back in.

---

### Model HC8000 Sump Pump Switch Limited Lifetime Warranty

STAK Enterprises Inc. warrants the **Model HC8000 Sump Pump Switch** to be free from defects in materials and workmanship for its normal, useful life, from the date of purchase. STAK Enterprises Inc. makes no other express warranty for this device. No agent, representative, dealer, or employee of STAK Enterprises Inc. has the authority to increase or alter the obligations or limitations of the warranty. The company's obligation of this warranty shall be limited to the repair or replacement of any part of the HC8000 which is found to be defective in materials or workmanship under normal use and service during the duration of product use by original product owner commencing with the date of purchase. Owner must pay all shipping charges necessary to replace product covered by this warranty. This warranty shall not apply to acts of God, nor shall it apply to products which, in the sole judgment of STAK Enterprises, Inc. have been subject to negligence, abuse, accident, tampering, alteration, misapplication, or improper installation. Units in need of repair should be returned, shipping prepaid, to

Customer Service Department  
STAK Enterprises, Inc.  
471-A Jennings Drive  
Lake in the Hills, IL 60156

THE DURATION OF ANY EXPRESS OR IMPLIED WARRANTY, INCLUDING THAT OF MERCHANTABILITY OR FITNESS FOR ANY PARTICULAR PURPOSES, SHALL BE LIMITED TO THE NORMAL, USEFUL LIFE OF THE PRODUCT, COMMENCING WITH THE DATE OF PURCHASE. IN NO CASE SHALL THE COMPANY BE LIABLE FOR ANY CONSEQUENTIAL OR INCIDENTAL DAMAGES FOR BREACH OF THIS OR ANY OTHER WARRANTY, EXPRESS OR IMPLIED, WHATSOEVER.

Some states do not allow the exclusion or limitation of incidental or consequential damages, so the above limitation or exclusion may not apply to you. This warranty gives you specific legal rights and you may also have other rights that vary from state to state.

**Questions or Comments Contact Us At:**

**[www.hydrocheckproducts.com](http://www.hydrocheckproducts.com) or [info@hydrocheckproducts.com](mailto:info@hydrocheckproducts.com) or 877-225-2124**